

Beijing Geofanci Tech Co.,Ltd

BarcodeDemo UserManual

02 Android BarcodeDemo UserManual

Diao xianhua

2014-4-4

1. Enter the menu, select "BarcodeDemo" , as pictures. There are a remind. Check it means that the equipment in a state of Focus Scanning

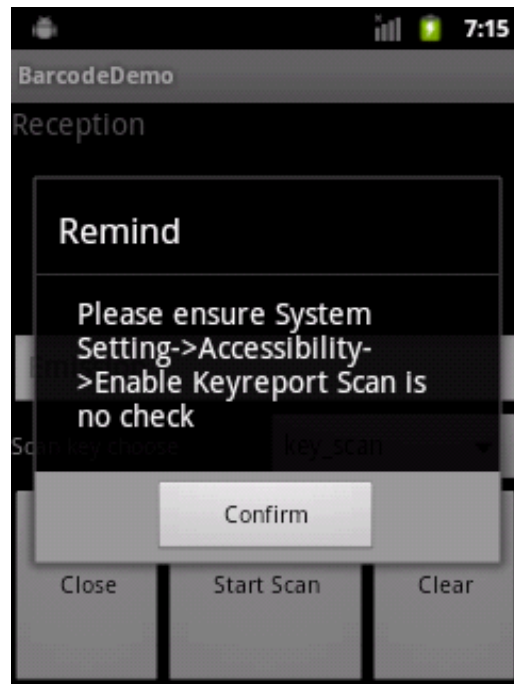

2. click "key_scan" to choose scan key , as picture,you have four chose: key_scan , key_F1 , key_F2 , key_F3 .

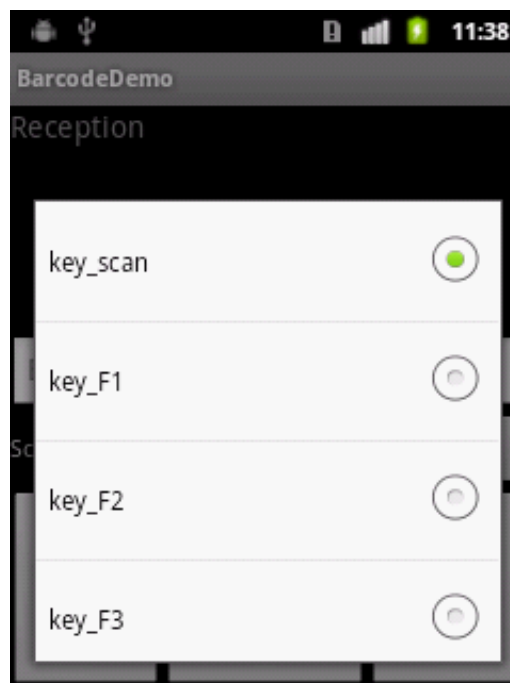

3. You can also click on "Start Scan" , "Clear" , "Close" associated operation.